

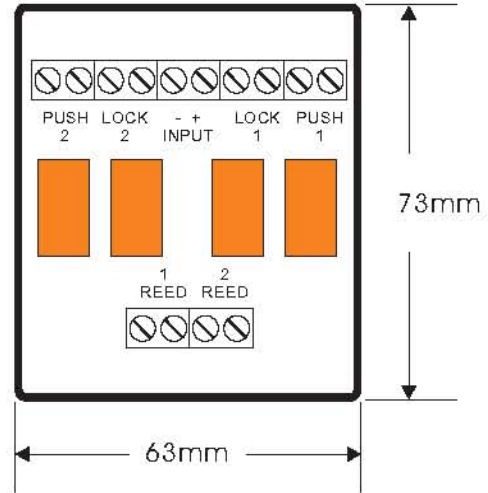

GEM



ILM-200
Interlocking Relay Module



Statement:

Interlocking relay module is an implement for two doors egress controlling, simply for fail-safe version electrified locking devices which come with signal output to integrate lock 1 and lock 2 alternately from changeover relays build in ILM-100, consequentially on all-inclusive sites application.

Specifications:

Case Size: 73(L)X63(W) mm
for Common Europe single-gang box sized
Relay rated 3A@125Vac, 24Vdc
12~24 V DC power input, input equivalent to Output voltage.
(Lock-1, Lock-2 contact output)
Operating Temper.: - 20~+70 C
Humidity: 0~95% non-condensing.

Schematic to make use of Interlocking Relay Module on sites

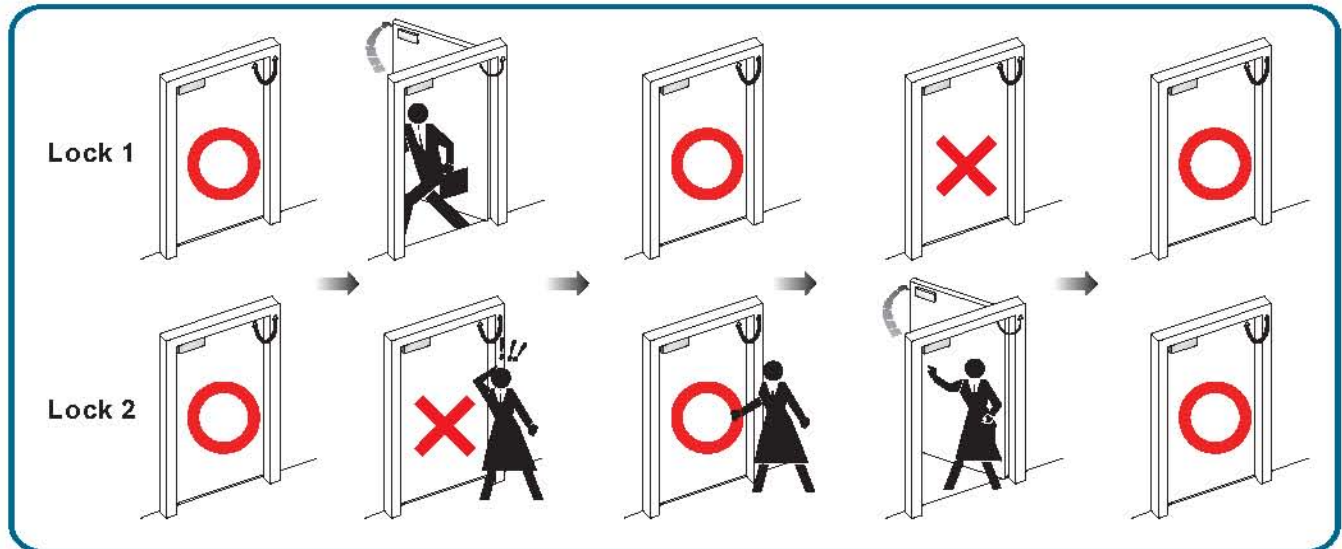

Upon both doors closed (Lock 1 and 2), any of the Lock 1 or 2 on door been opened (for example: Lock 1), the other lock remains (Lock 2) on door will not be able to open at the same time, until the opened door (Lock 1) been closed. Or, the alternation of Lock 1 and Lock 2 on doors taking its turns to feature of Interlocking perfectibility.



HARLE PHILIPPINES
An ISO9001:2015 Certified Company





GEM



ILM-200 Interlocking Relay Module

Connecting Diagram:

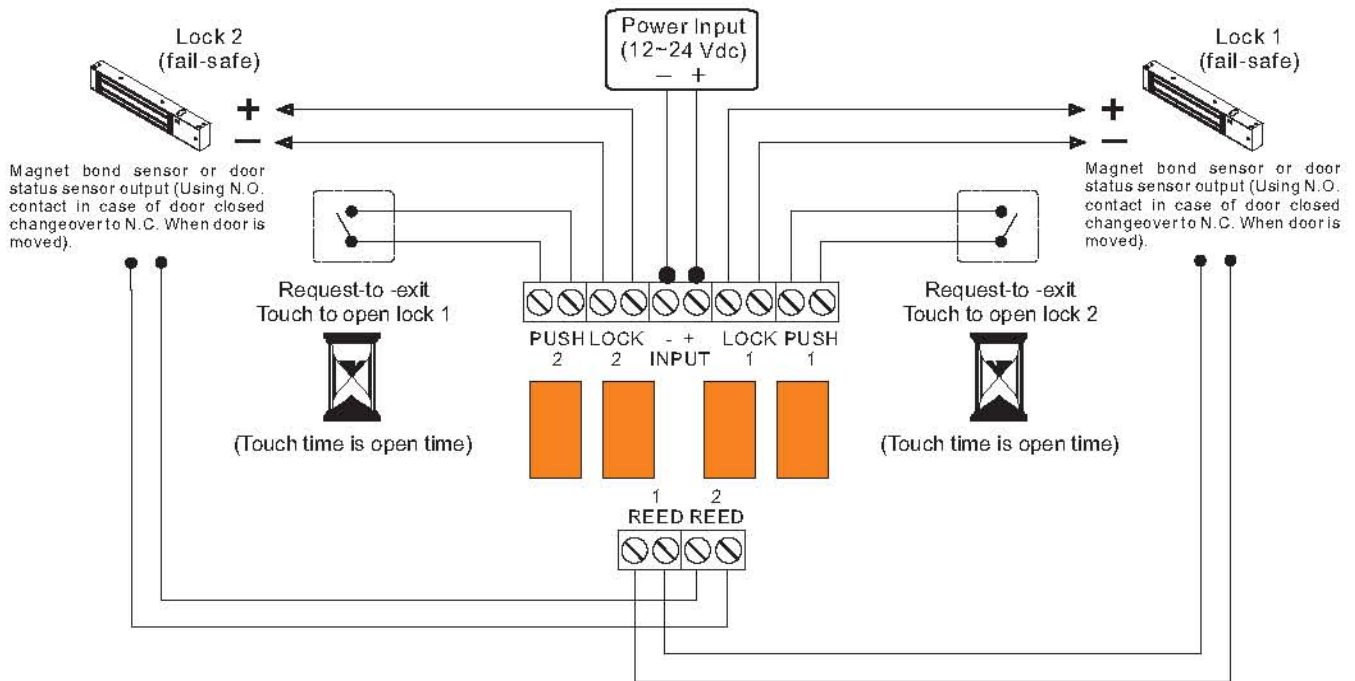

NOTE:

1. Interlocking relay module is an implement for **two doors** egress controlling and for **fail-safe** version electrified locking devices.
2. Input equivalent to Output (**Lock-1, Lock-2 contact output**) voltage.
3. The electrified locking devices qualify for the function is indispensable of **lock status sensor** or **door position sensor output** to indicates locked/unlocked or opened/closed.

Warranty:

GEM access control related accessories are warranted against defects in material and workmanship while used in normal service for a period of 1 year from the date of sale to the original customer.

Disclaimer:

The information and specifications printed in this manual are current at the time of publication. The GEM policy is one of continual development and improvement; therefore GEM reserves the right to change specifications without notice.



HARLE
PHILIPPINES
An ISO 9001:2015 Certified Company



The products are manufactured under an ISO 9001 & QC 080000 Certified Quality Management Program environment back its product quality, performance and commitment to customer satisfaction.