

**GERMCLEAN™ BACKPACK ELECTROSTATIC SPRAYER**  
**Model ESP-3014**

Instruction Guide



GERMCLEAN™ MODEL ESP-3014 BACKPACK ELECTROSTATIC SPRAYER

### SPECIFICATIONS

RATED VOLTAGE	17.5VDC
MAXIMUM POWER	15W
CHARGING TIME	3.5 Hours
ENDURANCE TIME	1.5 Hours
TANK CAPACITY	5.0L
BATTERY	2.5Ah X 2
BATTERY WORKING TIME	150 mins
OPERATING TIME OF ONE CHARGE	30 mins
SPRAY AREA ON FULL TANK	600m <sup>2</sup>
SPRAY VOLUME	140-290 ml/min
ENCLOSURE MATERIAL	PE
PARTICLE DIAMETER	80-100μM
QUIESCENT SPRAY DISTANCE	3-4 meters
OPERATING HUMIDITY	0-80%
SOUND PRESSURE LEVEL	60dB
OPERATING TEMPERATURE	-30-40°C
GROSS WEIGHT	5.3Kg
PACKING MEASUREMENT	34CM X 35CM X50CM



## COMPONENTS IDENTIFICATION

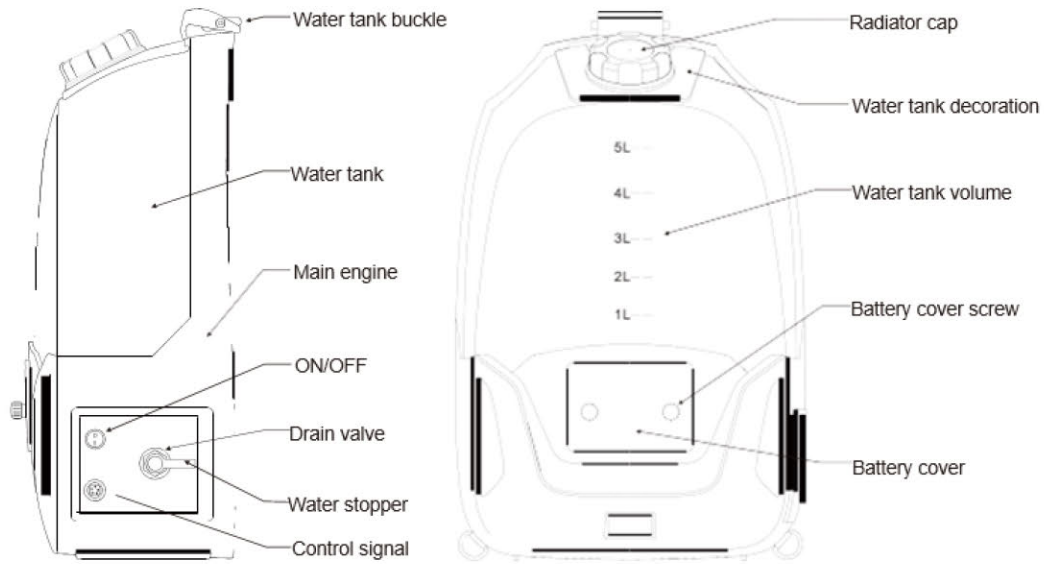

Figure 1- Front View

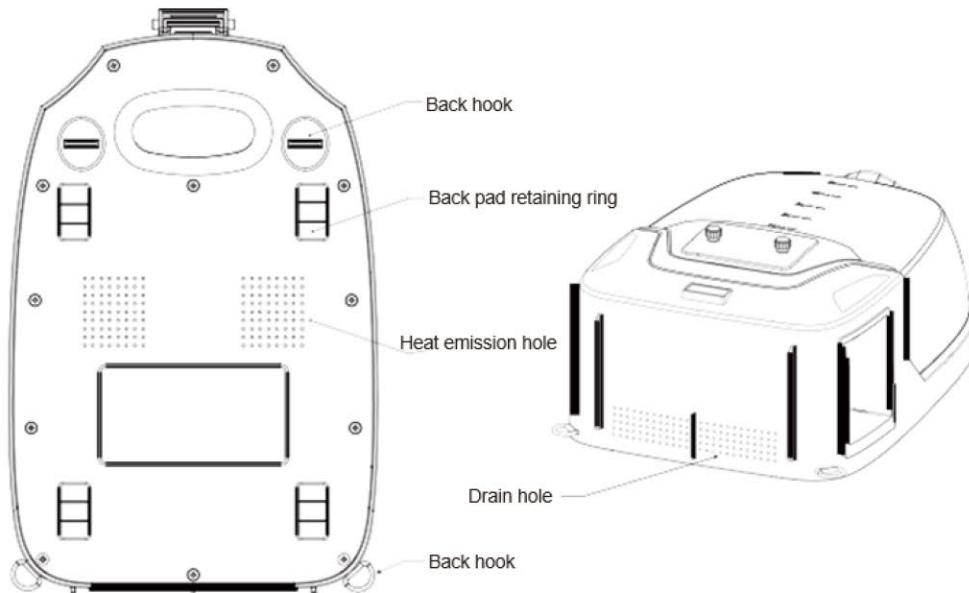

Figure 2- Back View



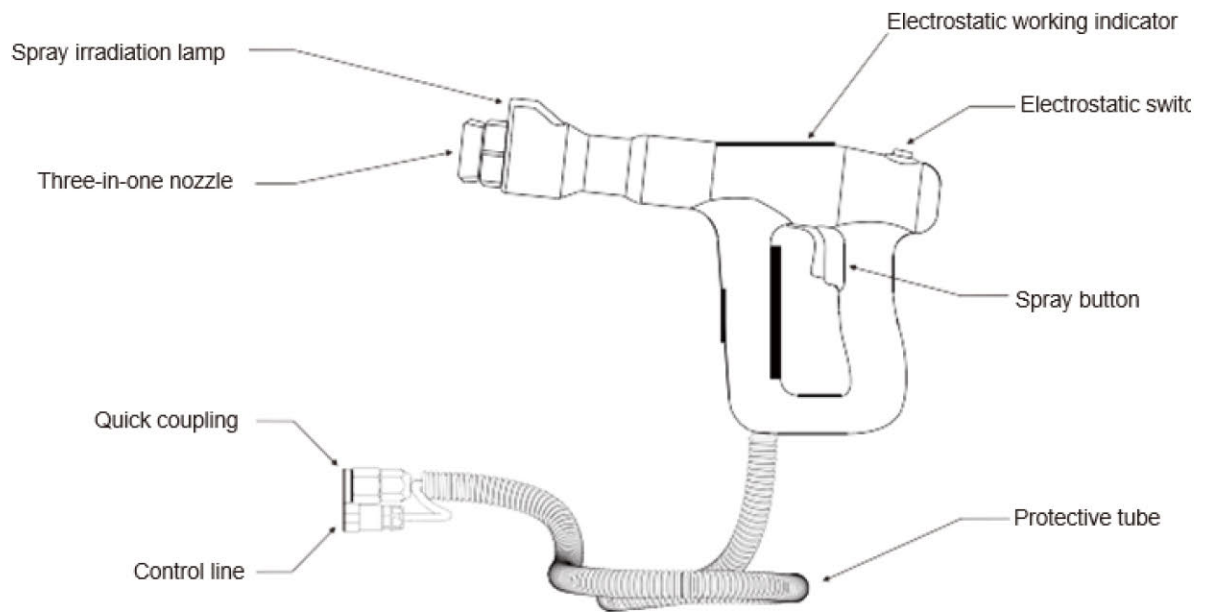

Figure 3 - Spray Nozzle



## USER INSTRUCTIONS

### Step 1- Add Liquid into Water Tank

1. In order to make this backpack sprayer in the best working condition, please take off the liquid tank and add disinfectant solution separately.
2. Open the liquid tank cover, add disinfectant solution or mixture of the liquid, be careful not to exceed the maximum volume of the tank 5L level mark to avoid liquid overflow.
3. Add the disinfectant solution slowly, the tank has a filtration function that can filter out any impurities that contaminate the tank.
4. Close the tank cover
5. Move back the liquid tank to the main unit. When the bottom of the liquid tank fit onto the main unit, the 2 convex points at the top of the liquid tank are aligned with the 2 concave points of the main unit and fit together securely. Lock the buckle.

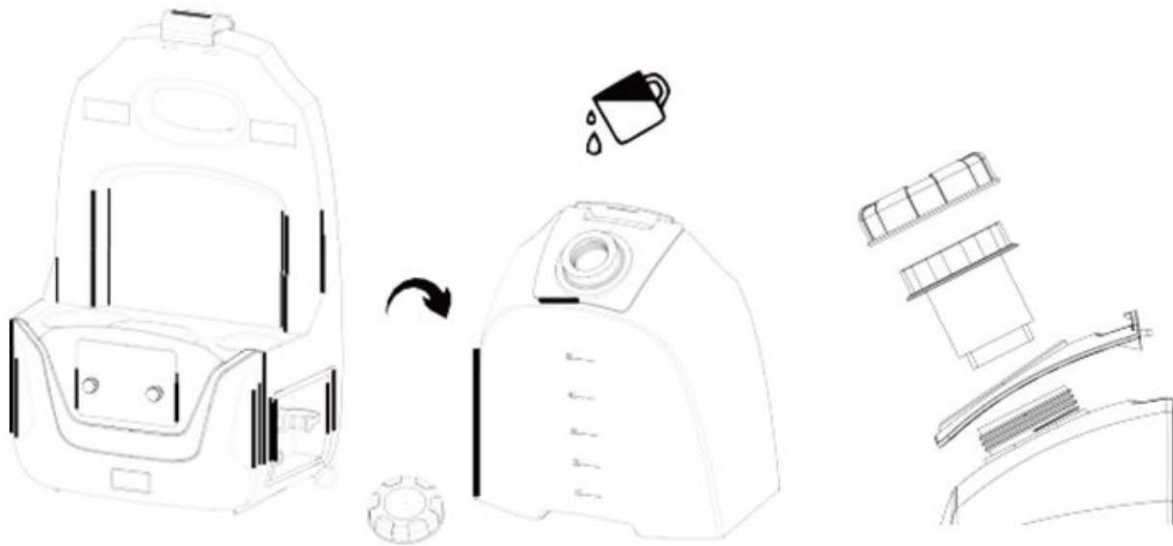

## Step 2 – Charging Battery

The power indicator will show how much power is left, if only one light is on, please charge the sprayer unit. If four lights are on, it means power is full and can continue use the sprayer.

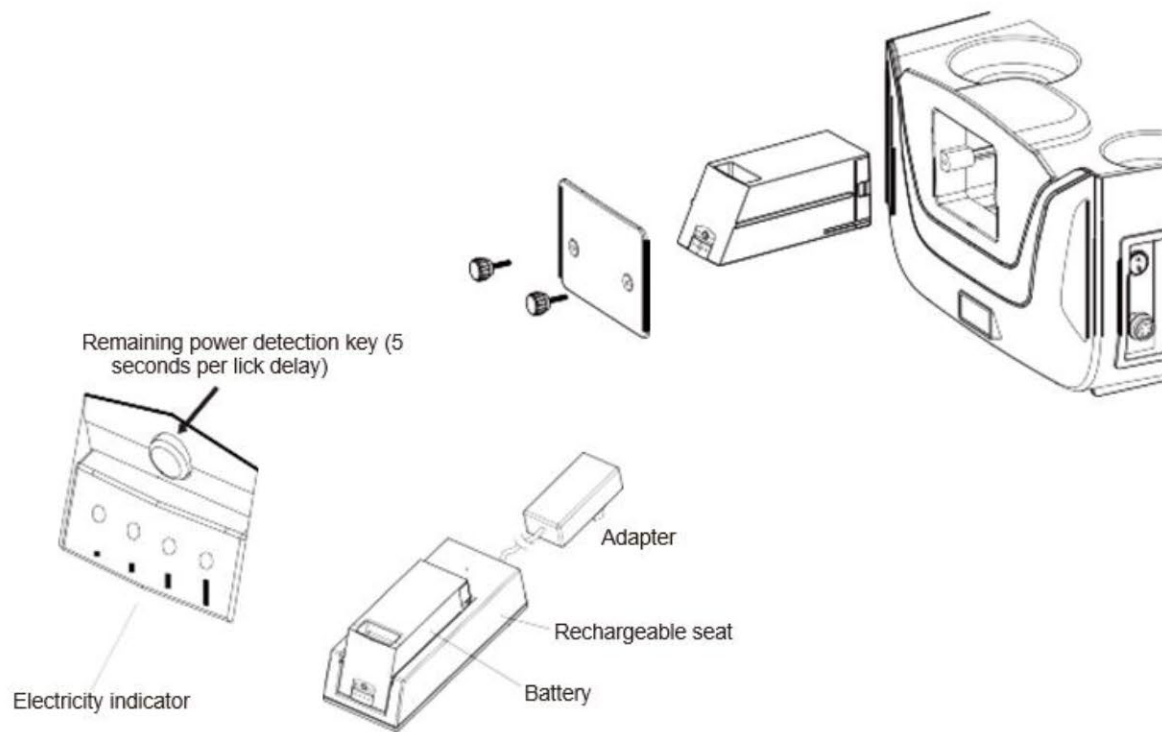

### Step 3 – Installation and Removing the Nozzle

Install nozzle assembly: insert the three-in-one nozzle into the front entrance of the handle, and rotate 90 degrees to lock the nozzle. When selecting different spray types, rotate the front end of the nozzle 120 degrees clockwise until you hear a click sound. The spray type will be selected.

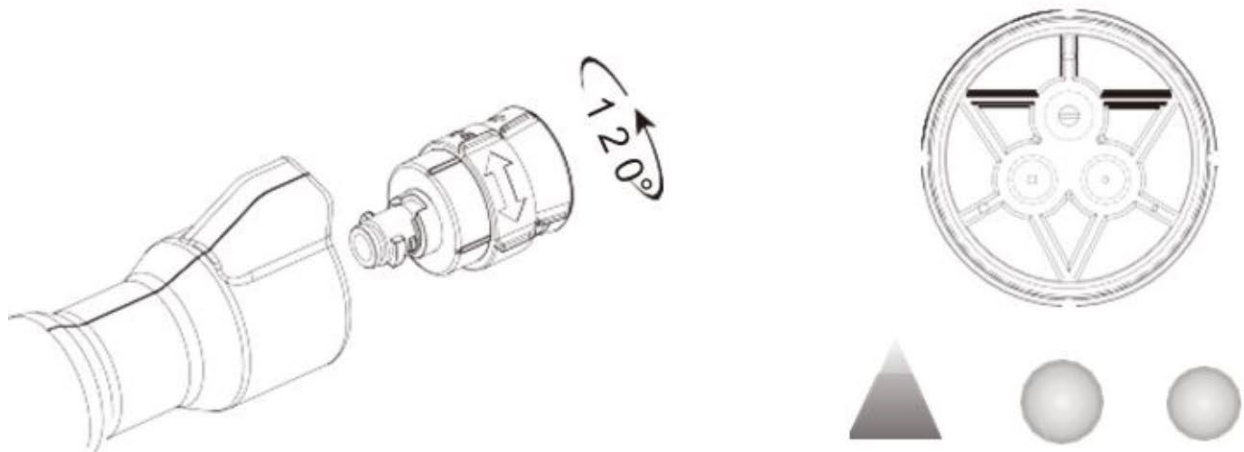

The spray is fan-shaped, large and small cylindrical, that can be selected according to the usage environment,

The entire nozzle can be removed from the handle by turning counterclockwise.



#### Step 4 – Install the Handle and Using the Sprayer

Insert the quick connector and control line. Turn on the main switch to standby state.

Fast joint should be slightly forced into the outlet valve, take out the front of orange part and then pull back.

Control line using buckle anti-freeze design, press the metal shrapnel before insertion, and then slowly align and insert, do not use force.



After all the accessories are assembled, hold down the spray key on the handle to spray.

With the innovative design of this sprayer, the surface area of the working object is about 30% higher than that of the traditional model.

With safety-certified lithium battery, high-quality electrostatic components and comfortable backpack style design enable spraying operation time and labor saving.

With 3 and 1 nozzle implementation, the sprayer can be used in a variety of spray occasions.

#### ATTENTION

1. Important - After each use, be sure to pour out the residual liquid from the tank and add flush with tap water for 3 minutes, residue liquid is either acidic and alkaline, long-term residue remain in the tank is not encouraged.
2. In spray operation, the walking speed should be uniform and the handle should be reduced to large swing, so as not to affect the user effect.
3. Avoid spraying on human body or animal during any spraying operation.
4. Product continuous working time cannot exceed 1 hour otherwise it will affect the battery life span.
5. The sprayer should be kept out-of-reach for children.
6. When the handle electrostatic switch is pressed, don't touch the spray in operation.





7. Unauthorized disassembling the battery will cause internal short circuit, fire explosion, harmful gas and other unpredictable events.
8. If the battery surface is found to be abnormal, such as water immersion marks, leakage, etc., please do not continue to use the sprayer.
9. Do not put the battery in fire or subject long-term high temperature exposure, otherwise the battery can explode.
10. If the sprayer is not in use for a long time, the battery should be removed and stored separately. The battery should be charged every 3 months to prevent it from being totally discharge.
11. The environment operating temperature of this backpack sprayer is 0°C-45°C. Ensure that the surrounding environment is dry and clean.
12. After long period of usage and the battery cannot be charged, the battery may need to be replaced.

### PACKING LIST

ACCESSORIES NAME	QUANTITY
Main Unit	1
Handle	1
Nozzle Set	1
Battery	1
Liquid Tank	1
Back Cushion	1
Rechargeable Unit	1
Power Adapter	1

### COMMON FAULTS AND SOLUTIONS

PHENOMENON	INSPECTION
Not Functioning	Is the battery fully charged and properly installed?
	Is the main power switch on and the control line plugged in?
	Handle spray switch in normal press position?
Spray Abnormal	Quick connector installed correctly?
	Whether the nozzle is properly turned in place or whether the nozzle hole is clogged with foreign impurities?
	Is the water tank and the filter screen between the tank and the main unit blocked?
Leakage	Outlet valve water leakage: Quick joint is tightly fit to connect outlet valve.
	Water tank leakage: Whether the outlet hole at the bottom of the water tank is connected correctly with the inlet hole of the main unit.

### CLEANING AND MAINTENANCE

1. Do not use strong corrosive chemical and solvents to clean the backpack sprayer. The process can cause surface damage or deformation.
2. Do not put the whole backpack sprayer into water for cleaning, this will damage the electronic circuit board in the unit.
3. Please keep the liquid tank empty if the sprayer is not in-use for a long duration.



**HARLE HOSPITALITY  
EQUIPMENT PHILS., INC.**

Unit 408 SEDCCO1 Bldg., 120 Rada corner Legazpi Sts.  
Legazpi Village, Makati City 1229, Philippines  
Tel. No. (632) 8892-8989 Fax No. (632) 8892-1688  
E-Mail: sales@harlephils.com

[www.harlephils.com](http://www.harlephils.com)